

SEEPLEX 26 - 12BN

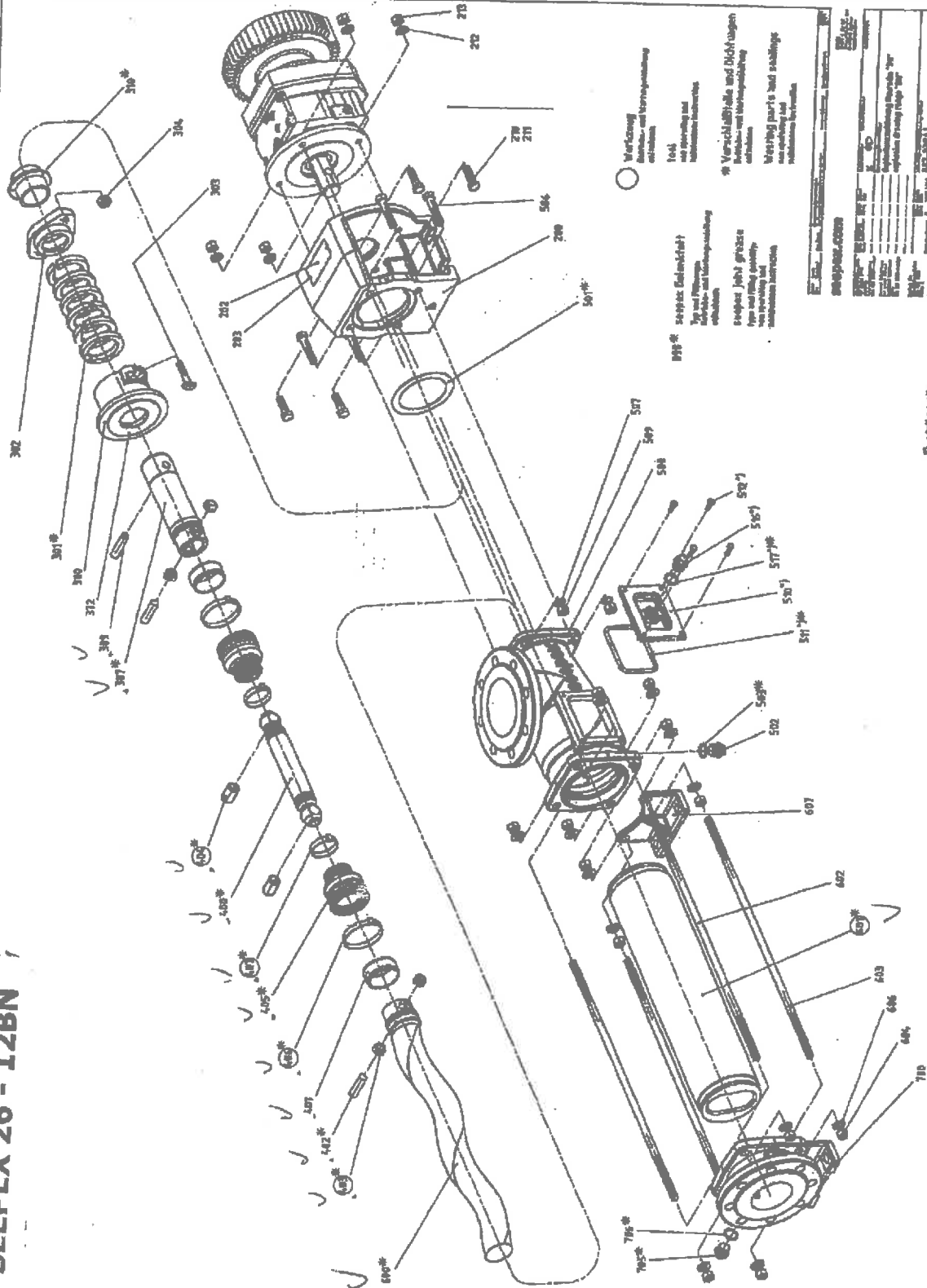

- Verklebung
Ankleben- und Verklebung
aufkleben
- 1041
mit Ölsperrung und
Schmiermittel
Schmiermittel
- 1042
Verschleißteile und
Nichttragteile
Ankleben- und Verklebung
aufkleben
- Verklebung parts sind
nicht tragend
nicht tragend und
nicht tragend

Part No.	Part Name	Part Description	Part Quantity
100	Pump Housing	Pump Housing	1
101	Shaft	Shaft	1
102	Impeller	Impeller	1
103	Drive Motor	Drive Motor	1
104	Seal	Seal	1
105	Bearing	Bearing	1
106	Washer	Washer	1
107	Lock Washer	Lock Washer	1
108	Pin	Pin	1
109	Pin	Pin	1
110	Pin	Pin	1
111	Pin	Pin	1
112	Pin	Pin	1
113	Pin	Pin	1
114	Pin	Pin	1
115	Pin	Pin	1
116	Pin	Pin	1
117	Pin	Pin	1
118	Pin	Pin	1
119	Pin	Pin	1
120	Pin	Pin	1
121	Pin	Pin	1
122	Pin	Pin	1
123	Pin	Pin	1
124	Pin	Pin	1
125	Pin	Pin	1
126	Pin	Pin	1
127	Pin	Pin	1
128	Pin	Pin	1
129	Pin	Pin	1
130	Pin	Pin	1
131	Pin	Pin	1
132	Pin	Pin	1
133	Pin	Pin	1
134	Pin	Pin	1
135	Pin	Pin	1
136	Pin	Pin	1
137	Pin	Pin	1
138	Pin	Pin	1
139	Pin	Pin	1
140	Pin	Pin	1
141	Pin	Pin	1
142	Pin	Pin	1
143	Pin	Pin	1
144	Pin	Pin	1
145	Pin	Pin	1
146	Pin	Pin	1
147	Pin	Pin	1
148	Pin	Pin	1
149	Pin	Pin	1
150	Pin	Pin	1
151	Pin	Pin	1
152	Pin	Pin	1
153	Pin	Pin	1
154	Pin	Pin	1
155	Pin	Pin	1
156	Pin	Pin	1
157	Pin	Pin	1
158	Pin	Pin	1
159	Pin	Pin	1
160	Pin	Pin	1
161	Pin	Pin	1
162	Pin	Pin	1
163	Pin	Pin	1
164	Pin	Pin	1
165	Pin	Pin	1
166	Pin	Pin	1
167	Pin	Pin	1
168	Pin	Pin	1
169	Pin	Pin	1
170	Pin	Pin	1
171	Pin	Pin	1
172	Pin	Pin	1
173	Pin	Pin	1
174	Pin	Pin	1
175	Pin	Pin	1
176	Pin	Pin	1
177	Pin	Pin	1
178	Pin	Pin	1
179	Pin	Pin	1
180	Pin	Pin	1
181	Pin	Pin	1
182	Pin	Pin	1
183	Pin	Pin	1
184	Pin	Pin	1
185	Pin	Pin	1
186	Pin	Pin	1
187	Pin	Pin	1
188	Pin	Pin	1
189	Pin	Pin	1
190	Pin	Pin	1
191	Pin	Pin	1
192	Pin	Pin	1
193	Pin	Pin	1
194	Pin	Pin	1
195	Pin	Pin	1
196	Pin	Pin	1
197	Pin	Pin	1
198	Pin	Pin	1
199	Pin	Pin	1
200	Pin	Pin	1

7. a. optional / optional

SEEPEX-A 35-6L



kind for the dismantling and assembly required, see document CHL397.04

Verschleißteile und Dichtungen

Working parts and drawings
also document QM.193.

Option / option

4. **900-234-2342 / info@unifirm.com**

DATE	TIME	REPORT MADE AT	NAME OF VESSEL	NAME OF COMMANDER	NAME OF OBSERVER
10/10/54	1400	San Francisco	USSC 1000	W. J.
<p>1. <u>DESCRIPTION OF VESSEL</u></p> <p>2. <u>NAME OF VESSEL</u></p> <p>3. <u>TYPE OF VESSEL</u></p> <p>4. <u>REGISTRATION</u></p> <p>5. <u>COLOUR</u></p> <p>6. <u>MARKINGS</u></p> <p>7. <u>WEIGHT</u></p> <p>8. <u>LENGTH</u></p> <p>9. <u>BREADTH</u></p> <p>10. <u>DRAUGHT</u></p> <p>11. <u>ENGINE</u></p> <p>12. <u>POWER</u></p> <p>13. <u>CREW</u></p> <p>14. <u>CARGO</u></p> <p>15. <u>REMARKS</u></p>					